

TFB Custom Filler Bar

US Patent 10550590 B2

All-Purpose Job-Built Filler Bars

Make your own custom filler panels or transition panels on the spot

Steel Dog® Custom Filler Bars™ are strong, extruded aluminum channels with attached, sliding latch hardware to connect 1-1/8" form panels to 3/4" plywood. With Filler Bars™, you can make custom fillers on the job with inexpensive 3/4" plywood for a myriad of uses.

FEATURES:

- Aluminum channels are lightweight, strong, and corrosion-resistant
- Latches and bolt plates can be easily moved to match any bar pattern
- Use inexpensive 3/4" plywood to make your own fillers

USES:

- Custom Fillers
- Pass-Throughs
- Step-ups
- Transition panels
- Architectural elements
- Custom-made corners

MATERIAL: Extruded aluminum channels. Latch hardware carbon steel; latches heat-treated medium carbon steel

MAXIMUM FILLER WIDTH: 14 inches suggested (up to 24" possible with proper waling to minimizing deflection of 3/4" plywood)

MINIMUM FILLER WIDTH: 6.5 inches

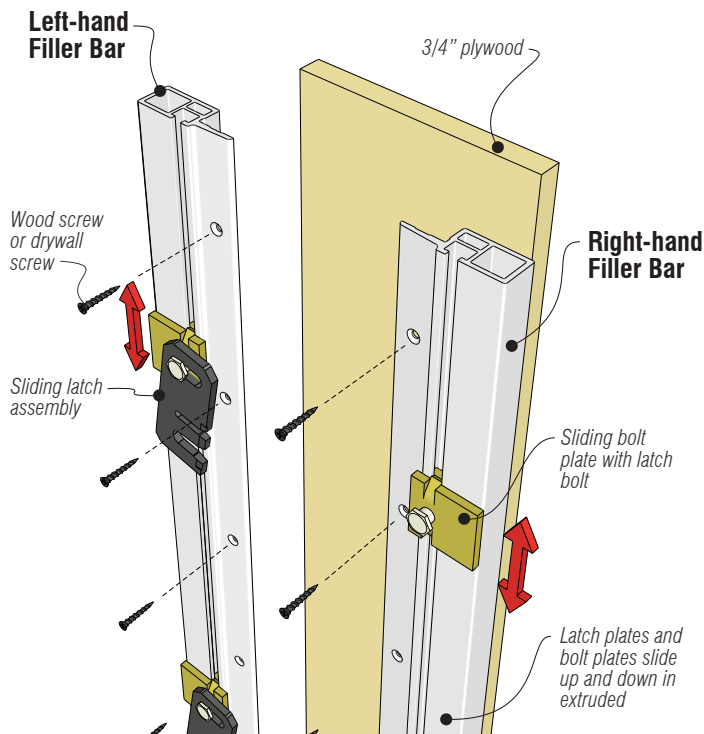
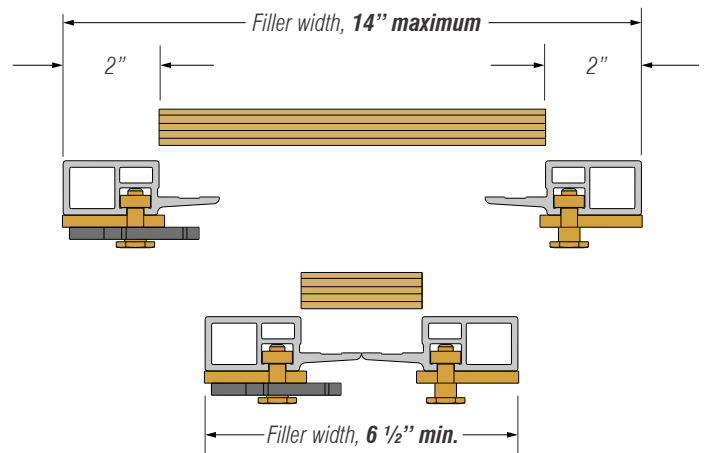
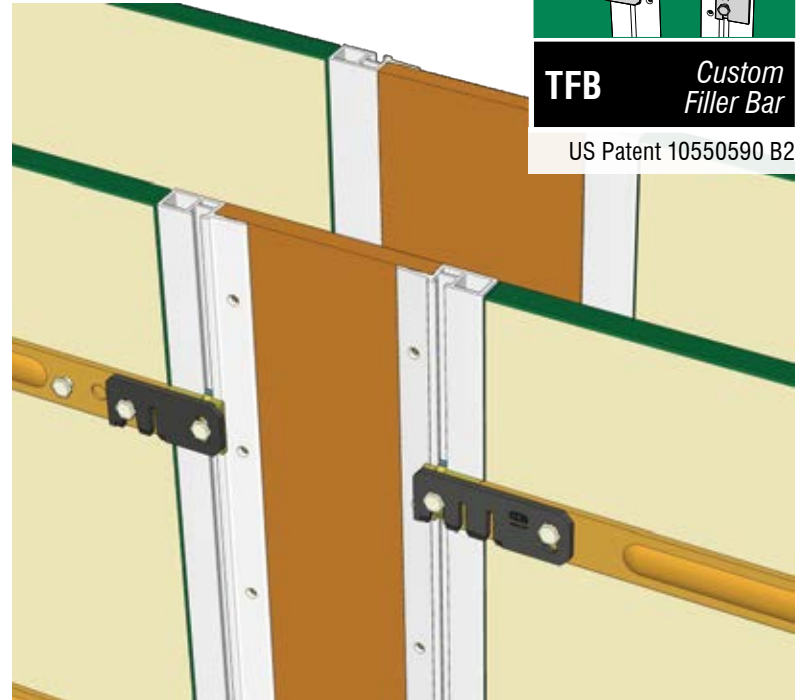

ASSEMBLY and USE:

- Cut the 3/4" plywood panel 4" narrower than desired filler width (allow 2" Filler Bar width each side)
- Screw Filler Bars to plywood, using holes provided. #8 or larger screws recommended, using holes on 6" spacing. Thru-bolts and nuts are recommended for stronger connection on frequently reused fillers.
- Loosen hex head shoulder bolts to slide latch or bolt plate assemblies up or down to match adjoining panel bars

CAUTION

- Use caution where there are large spreading forces, such as near outside corners. Strength of panels made with TFB is limited by the shear strength of the screw connecting the aluminum to the plywood.
- If necessary, reinforce with waling or perforated banding

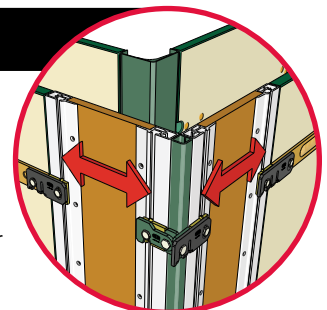

Common Applications

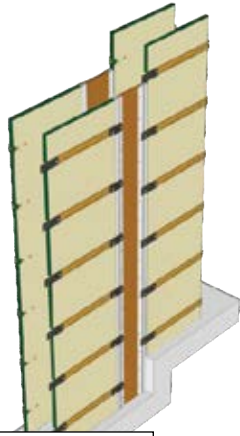

Custom Filler
4.5" to 14" width

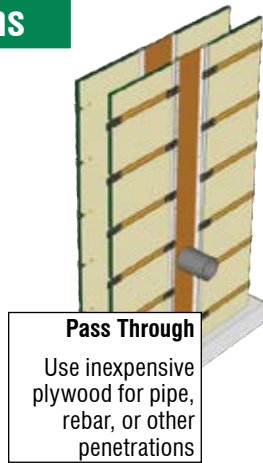

Pass Through
Use inexpensive plywood for pipe, rebar, or other penetrations



Panel Transition
4-Bar to 6-Bar shown.

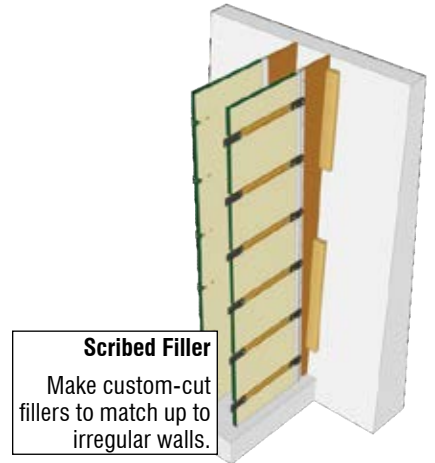

Scribed Filler
Make custom-cut fillers to match up to irregular walls.

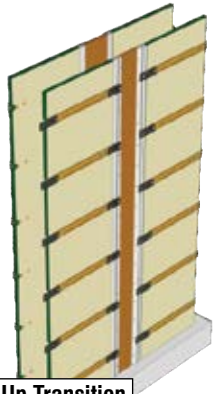

Step-Up Transition
Accommodate any height difference

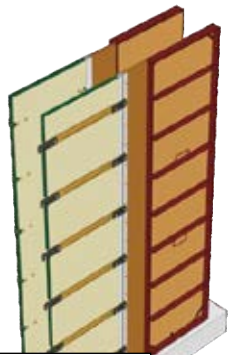

1-1/8"-to-Steel Ply® Transition
Use filler angles on Steel Ply® side.

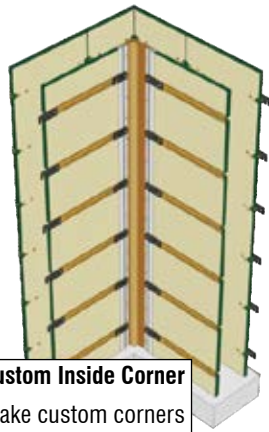

Custom Inside Corner
Make custom corners with plywood and lumber for unusual sizes.

ORDER INFO

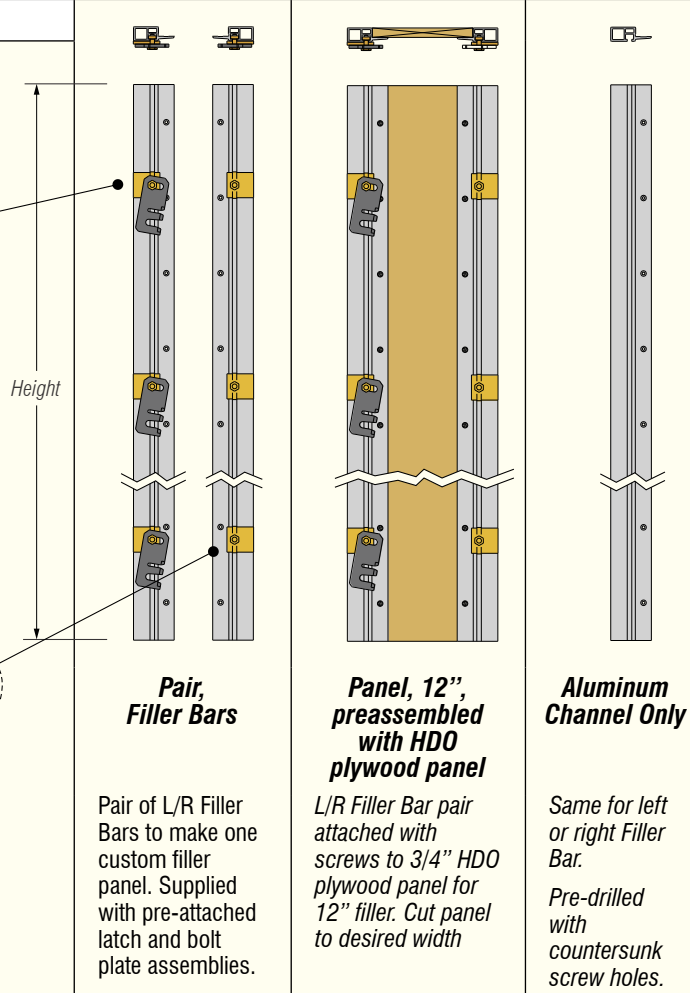
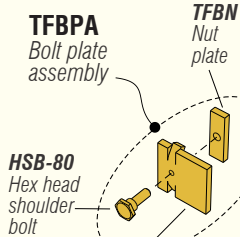
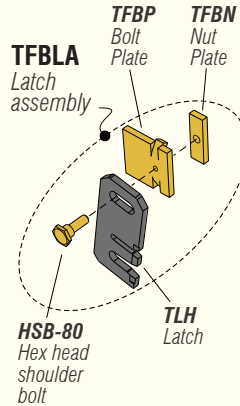

Height

4 ft	Product Code	TFB-48	TFB-48PAN	TFB-48A
	No. of Latches	3	3	
	Weight	15 lbs	21 lbs	5.1 lbs
5ft-4in	Product Code	TFB-64	TFB-64PAN	TFB-64A
	No. of Latches	4	4	
	Weight	18 lbs	27 lbs	6.8 lbs
8ft	Product Code	TFB-96	TFB-96PAN	TFB-96A
	No. of Latches	6	6	
	Weight	29 lbs	42 lbs	10.2 lbs
9 ft	Product Code	TFB-108	TFB-108PAN	TFB-108A
	No. of Latches	6	6	
	Weight	32 lbs	46 lbs	11.5
9ft-4in	Product Code	TFB-112	TFB-112PAN	TFB-112A
	No. of Latches	7	7	
	Weight	34 lbs	49 lbs	11.9 lbs
10ft	Product Code	TFB-120	TFB-120PAN	TFB-120A
	No. of Latches	7	7	
	Weight	35 lbs	52 lbs	12.7 lbs

Pair, Filler Bars

Pair of L/R Filler Bars to make one custom filler panel. Supplied with pre-attached latch and bolt plate assemblies.

Panel, 12", preassembled with HDO plywood panel

L/R Filler Bar pair attached with screws to 3/4" HDO plywood panel for 12" filler. Cut panel to desired width

Aluminum Channel Only

Same for left or right Filler Bar. Pre-drilled with countersunk screw holes.